

EWN.FP EWN.



Wing nuts



ELESA Original design

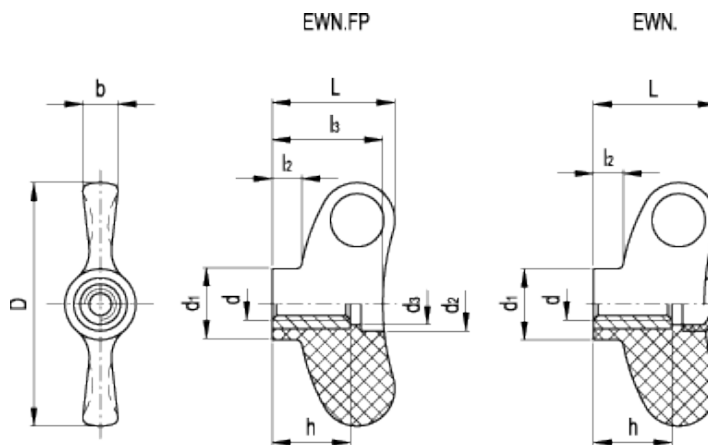

technical informations

Material

Glass-fibre reinforced polyamide based (PA) technopolymer. Resistant to solvents, oils, greases and other chemical agents.

Colour

Grey-black, matte finish.

Assembly

- EWN.FP: brass boss, tapped through hole, without cap.
- EWN: brass boss, tapped through hole, with cap.

Cap for EWN.

Technopolymer in Ergostyle colours, matte finish; supplied assembled, press-fit assembly, removable by a screwdriver. Available also as accessory sold separately (see caps table).

Ergonomy and design

The slightly concave marks on the wings help to position the finger in order to apply the maximum force when tightening.

C1 RAL 7021 C2 RAL 2004 C3 RAL 7035 C4 RAL 1021 C5 RAL 5024 C6 RAL 3000



Standard Elements		Main dimensions								Mounting hole		C #	Weight
Code	Description	D	L	d ₁	l ₂	b	d ₂	d ₃	l ₃	d _{6H}	h	[Nm]	g
223122-C0	EWN.48 FP-M5-C0	47	24	13.5	5.5	7	10	8.5	21.5	M5	12	-	10
223123-C0	EWN.48 FP-M6-C0	47	24	13.5	5.5	7	10	8.5	21.5	M6	12	-	9
223124-C0	EWN.48 FP-M8-C0	47	24	13.5	5.5	7	10	8.5	21.5	M8	12	-	8
223132-C0	EWN.55 FP-M6-C0	55	28	16	6.5	8	12	10.5	25	M6	18	-	19
223133-C0	EWN.55 FP-M8-C0	55	28	16	6.5	8	12	10.5	25	M8	18	-	18
223152-C0	EWN.70 FP-M8-C0	70	36	20	8	10	15	13	32	M8	20	-	32
223153-C0	EWN.70 FP-M10-C0	70	36	20	8	10	15	13	32	M10	20	-	31
223216-*	EWN.48 B-M5-*	47	24	13.5	5.5	7	-	-	-	M5	12	10	11
223221-*	EWN.48 B-M6-*	47	24	13.5	5.5	7	-	-	-	M6	12	12	10
223226-*	EWN.48 B-M8-*	47	24	13.5	5.5	7	-	-	-	M8	12	15	9
223236-*	EWN.55 B-M6-*	55	28	16	6.5	8	-	-	-	M6	18	20	20
223241-*	EWN.55 B-M8-*	55	28	16	6.5	8	-	-	-	M8	18	26	19
223406-*	EWN.70 B-M8-*	70	36	20	8	10	-	-	-	M8	20	45	34
223411-*	EWN.70 B-M10-*	70	36	20	8	10	-	-	-	M10	20	58	33

* Complete the code and the description of the standard item needed by adding the index of the colour of the cap (C1,.....,C6) ex: 223216-C2 EWN.48 B-M5-C2# "Max limit Tightening torque" means the max torque value at which the metal insert, in normal conditions of use, is perfectly and strongly anchored to the plastic material.

Code	Description	Cap for
29752-*	ECA.W2-*	EWN.48
29753-*	ECA.W3-*	EWN.55
29754-*	ECA.W4-*	EWN.70

* Complete the code and the description by adding the index of the colour (C1,.....,C6).

This product had the following design awards:



ELESA and GANTER models all rights reserved in accordance with the law. Always mention the source when reproducing our drawings.

STANDARD MACHINE ELEMENTS WORLDWIDE